

CABINET AND LOCKER SYSTEMS

with drying and hygiene function

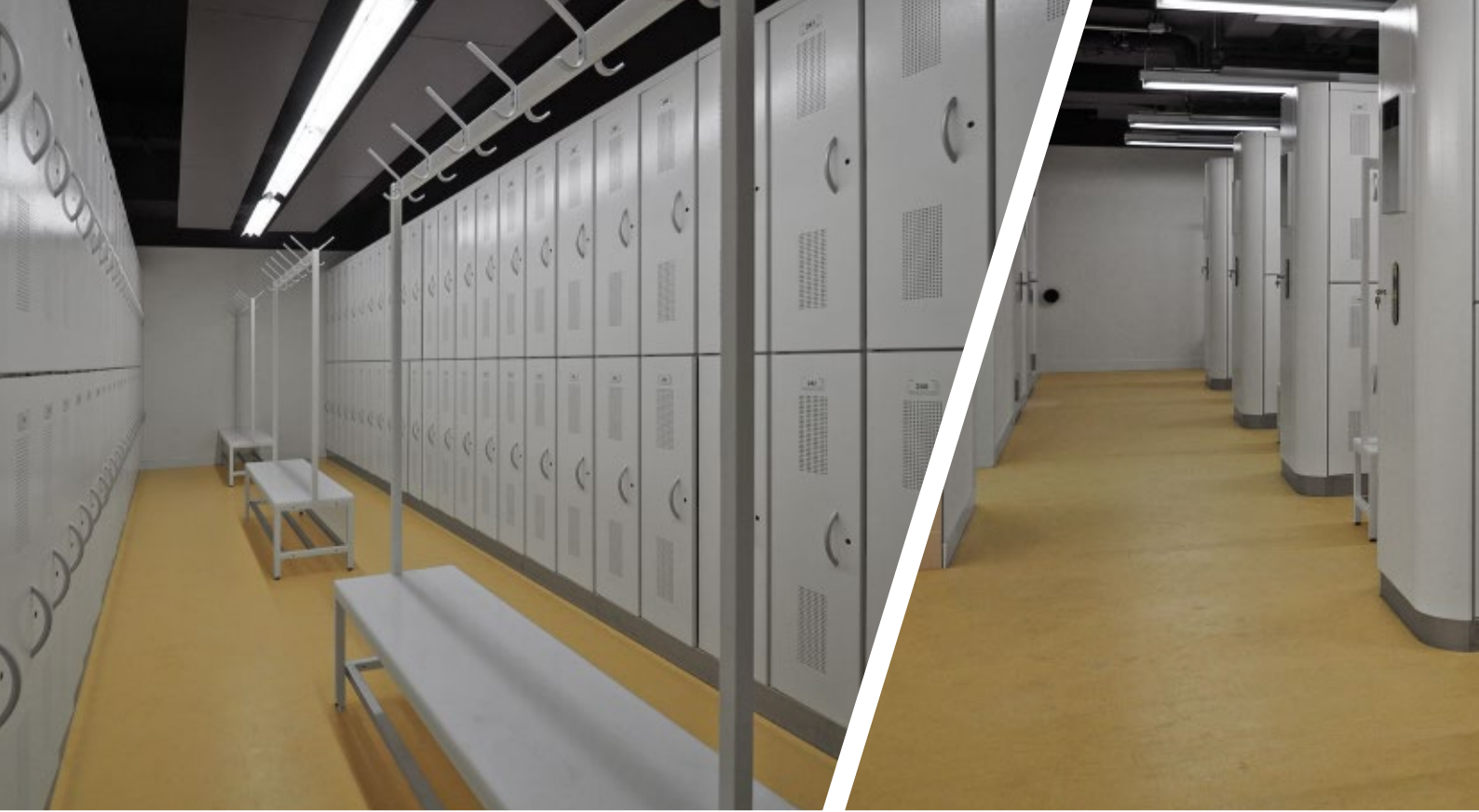

GLADEK **TECHNIK**



Welcome!

GLADEK TECHNIK

High Performance Hygienic Drying Solutions

A profitable investment that's bound to pay!

GLADEK TECHNIK is the global partner you can rely on for drying and condensation processes as well as germ and odour reduction for all types of clothing and equipment.

Investing in GLADEK TECHNIK condensation drying systems for work clothing will make a huge contribution to improving the hygiene and health of your staff and also to prolonging the life expectancy of your high-quality equipment.

Benefit from a manufacturer who has now been defining and perfecting industrial drying technology for over 10 years.

We'll help you find the solution that's perfectly tailored to your specific needs.



Contents

More than just storage	4
Optional features for greater flexibility	4
The hygiene concept	6
ECO technology	6
What else do you get?	8
Applications	10
Condensation drying locker systems	12
Condensation drying cabinet systems	14
Cabinet systems	16
Wall dryers	20
Optional accessories	24
Custom planning	22
Environment	23





More than just storage

Unlike simple lockers, **GLADEK TECHNIK** cloakroom cupboards give your staff the added benefit of professional and efficient drying for work clothing and equipment.

The **GLADEK TECHNIK** hygiene concept is also guaranteed to keep germs and odours at bay. The cabinets can be controlled and provide optimum drying results at whichever time you define.

Optional features for greater flexibility

Depending on your requirements, you can choose from a whole host of optional functions:

- ▶ Various control systems: from analogue and time-based to PLC controllers you can integrate into your network.
- ▶ We can offer locking and unlocking systems including everything from simple rotary bolt locks for padlocks or cylinder locks to electronic locking systems.





The hygiene concept

Put an end to germs and odours! Our drying systems pride themselves on being extremely proficient at eliminating microorganisms, such as germs and bacteria, as well as unpleasant odours from work clothing and equipment. What is ozone? Nothing more than a gas. It gets almost everywhere. The ozone molecule is made up of three oxygen atoms, i.e. O₃, rather than O₂ as the oxygen we breathe. This third atom and the molecule's internal bonding make it very reactive. Up in the ozone layer, the gas protects us from harmful UV radiation. Down on earth, in the environment we live in, ozone in excessive dosages tends to be a hazard for human beings and animals. And this also applies to germs, viruses and fungi. When they do come into contact with ozone (in the right dosage, of course), their cell walls are destroyed in hardly any time at all. They are unable to generate any immune response. That is also the reason why viruses or bacteria can't become resistant to ozone. Following response, ozone breaks down into pure oxygen, O₂.

ECO technology

Condensation drying as energy-efficient as this lets you benefit from a closed system that channels the moisture directly into the drain.

No moisture problems from mould. No additional ventilation systems are needed in communal rooms. You are also rewarded with short drying times and 60 % less energy consumption.





GT Boot 5 Power

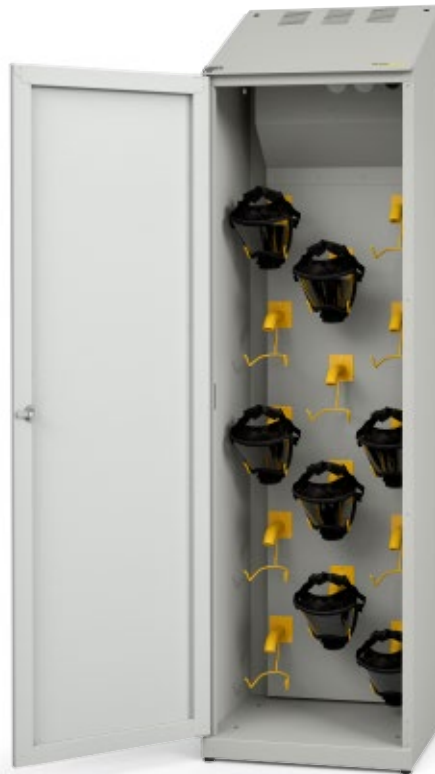

GT Mask 14 TS/GT Helmet 8 TS



What else do you get?

Air dehumidification in changing rooms

All cloakroom cupboards benefit from optimised air circulation for ideal drying results and for removing air humidity via a condensation system. Changing rooms require no ventilation systems.

Controlled drying

Temperature is constantly controlled and maintained by heating elements at a level that dries fabrics as gently as possible. Different control options let you set the drying system in any locker and cloakroom cupboard to come on and operate only when it is actually needed. This saves time and money!

Durable and cleverly designed

Of sturdy construction, the wardrobe cupboards in high-quality sheet steel are guaranteed to provide long-lasting satisfaction. Optimised in design, our drying solutions also make the perfect choice for smaller-type spaces.

For a sense of well-being and good health

Professionally dried work clothing and equipment will instil a sense of well-being in your staff while also boosting their motivation. Besides work clothing, there's also ample space for keeping personal belongings.



GT Eco Optimum 1300 (condensation dryer)



Applications

Solutions for drying, disinfecting and neutralising odours in clothing and equipment, such as jackets, trousers, boots, gloves and helmets.

- ▶ Shipbuilding / maritime
- ▶ Fishing sector
- ▶ Infrastructure (roads, railways, airports)
- ▶ Food industry
- ▶ Fire-fighting
- ▶ Military and police
- ▶ Energy providers
- ▶ Chemical and pharmaceutical industry
- ▶ Public utilities
- ▶ Building and construction industry
- ▶ Production and maintenance
- ▶ Forestry
- ▶ Agriculture
- ▶ Sports clubs
- ▶ Golf
- ▶ Winter sport
- ▶ Hospitals
- ▶ Private households



Condensation drying locker systems



GT Eco Individual 300-450



GT Individual 300-450 **Drying locker / condensation drying**

Door mounted on left (or, if requested, on right)

- 1 shelf at top
- 1 clothes rail
- 2 all-purpose holders on the inside of the door
- 1 pairs of internally ventilated glove nozzles, 260 mm
- 1 pair of internally ventilated shoe nozzles, 320 mm
- 1 clothes hanger specifically designed for jacket and trousers

Rotary bolt lock for padlock (or as specified by customer)

Cabinet carcass: steel, galvanised, powder-coated in RAL 7038

Door: steel, galvanised, powder-coated in RAL 7035
(or as specified by customer);

Trim panels in RAL 7038

Dimensions HxWxD in mm: 240 x 300/350/400/450 x 550



GT Eco Individual 600-900
Drying locker / condensation drying

left-hand door (white): door mounted on left

- 1 shelf at top
- 2 all-purpose holders on the inside of the door
- 1 clothes rail
- 1 shelf at bottom
- 1 pair of internally ventilated shoe nozzles, 320 mm
- 1 clothes hanger specifically designed for jacket and trousers

right-hand door (black): door mounted on right

- 1 shelf at top
- 2 all-purpose holders on the inside of the door
- 1 clothes rail
- 1 pairs of internally ventilated glove nozzles, 260 mm
- 1 pair of internally ventilated shoe nozzles, 320 mm
- 1 clothes hanger specifically designed for jacket and trousers

Cabinet carcase: steel, galvanised, powder-coated in RAL 7038

Door: steel, galvanised, powder-coated in RAL 7035

1 rotary bolt lock for padlock

including Air ducts with trim panel in RAL 7038

Locker/door dimensions

HxWxD in mm: 2230 x 300/350/400/450 x 550



GT Eco Individual 600-900

Condensation drying cabinet systems



GT Eco Optimum 650



24 h programmable timer

6 h timer



GT Eco Optimum 650 drying cabinet / condensation dryer

1 garment rail

- choice of optional additional features -

Ozone for germ and odour reduction

Eco unit, condensation-water drain with ball valve (for connection on site)

24 h programmable timer and 6 h timer

Connection cable approx. 1800 mm including Schuko earthed plug

Cabinet carcass: steel, galvanised, powder-coated in RAL 7038

Door: steel, galvanised, powder-coated in RAL 7035

Rotary bolt lock for padlock

Power supply: 230 V/ 1.4 kW

Dimensions HxWxD in mm: 2110 x 650 x 830



7 d / 24 h programmable timer
6 h timer



GT Eco Optimum 1300

Available features:

- ▶ Clothes hanger specifically designed for jacket and trousers
- ▶ Nozzle adapter plates, stainless steel
- ▶ Internally ventilated glove nozzles
- ▶ Internally ventilated boot nozzle
- ▶ Internally ventilated helmet nozzle (please specify make)
- ▶ Internally ventilated mask nozzle (please specify make)
- ▶ Storage compartment
- ▶ 2nd clothes rail
- ▶ All-purpose holder on the inside of the door
- ▶ Base section with 4 castors
- ▶ Supplied in kit form (disassembled in a wooden crate)

GT Eco Optimum 1300

Drying cabinet / condensation dryer

1 garment rail

- choice of optional additional features -

Ozone for germ and odour reduction

Eco unit, condensation-water drain with ball valve (for connection on site)

7 d / 24 h programmable timer and 6 h timer

Connection cable approx. 1800 mm including Schuko earthed plug

Cabinet carcass: steel, galvanised, powder-coated in RAL 7038

Door: steel, galvanised, powder-coated in RAL 7035

Rotary bolt lock for padlock

Power supply: 230 V / 1.4 kW

Dimensions HxWxD in mm: 2110 x 1300 x 830

Cabinet systems



GT Glove 10 TS



GT Glove 10 TS drying cabinet

10 pairs of internally ventilated glove nozzles, 260 mm

Ozone for germ and odour reduction

Top sloping at 26°

Air-circulating fan

High-performance heating element

6 h t timer and 24 h programmable timer

Connection cable 1800 mm including Schuko earthed plug

Cabinet carcase: steel, galvanised, powder-coated in RAL 7038

Door: steel, galvanised, powder-coated in RAL 7035

Rotary bolt lock for padlock

Connected load: 230 V / 0.85 kW

Dimensions HxWxD in mm: 2110 x 300 x 500



GT Boot 5 TS



GT Boot 10 TS



GT Boot 5/10 TS drying cabinet

5/10 pairs of internally ventilated shoe/boot nozzles, 320 mm, up to a shaft height of 360 mm

Ozone for germ and odour reduction

Top sloping at 26°

Air-circulating fan

High-performance heating element

6 h t timer and 24 h programmable timer

Connection cable 1800 mm including Schuko earthed plug

Cabinet carcass: steel, galvanised, powder-coated in RAL 7038

Door: steel, galvanised, powder-coated in RAL 7035

Rotary bolt lock for padlock

Connected load: 230 V / 0.35 kW/ 0.7 kW

Dimensions HxWxD in mm: 2110 x 300/600 x 500

Cabinet systems



GT Mask 14 TS or GT Helmet 8 TS drying cabinet

14 / 8 Internally ventilated mask or helmet nozzles
(please specify make)

Ozone for germ and odour reduction

Top sloping at 26°

Air-circulating fan

High-performance heating element

6 h t timer and 24 h programmable timer

Connection cable 1800 mm including Schuko
earthed plug

Cabinet carcass: steel, galvanised, powder-coated
in RAL 7038

Door: steel, galvanised, powder-coated in RAL
7035

Rotary bolt lock for padlock

Connected load: 230 V / 0.7 kW

Dimensions HxWxD in mm: 2110 x 600 x 500



GT Mask 14 TS



Wall dryer



GT Boot 5/10 Power wall dryer

5/10 pairs of internally ventilated shoe/boot nozzles, 320 mm, up to a shaft height of 360 mm

Ozone for germ and odour reduction

Circulating air fan, high-performance heating element

6 h t timer and 24 h programmable timer

Connection cable approx. 1800 mm including Schuko earthed plug

Wall dryer made of steel powder-coated in RAL 7035

Power supply: 230 V/ 0.85 kW/1.9 kW

Dimensions HxWxD in mm: 1984 x 260/524 x 385

NOTE: Wall mounting imperative!

Not recommended for operation below an ambient temperature of 15°C.

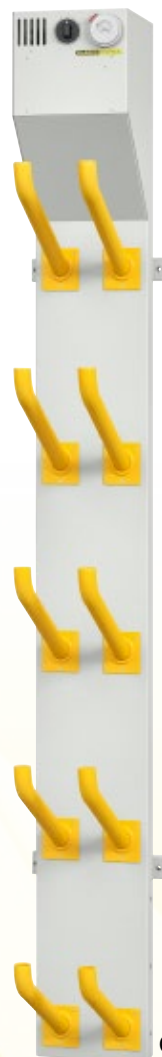

GT Boot 5 Power

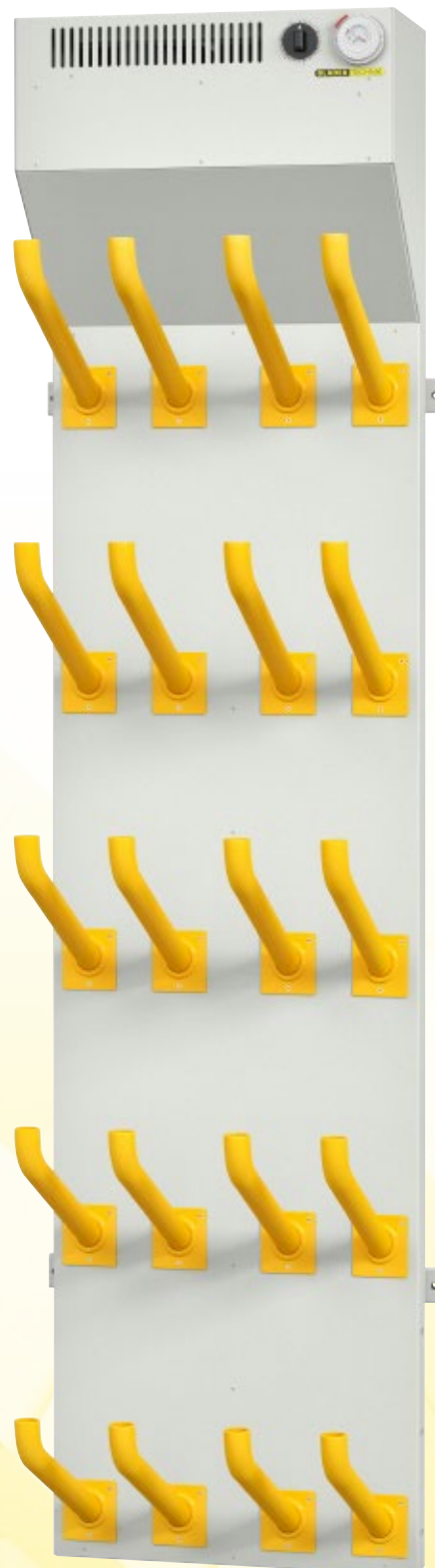

GT Boot 10 Power



6 h timer

24 h programmable timer



GT Glove 10 Power wall dryer

10 pairs of internally ventilated glove nozzles

Ozone for germ and odour reduction

Circulating air fan, high-performance heating element

6 h t timer and 24 h programmable timer

Connection cable approx. 1800 mm including Schuko earthed plug

Wall dryer made of steel powder-coated in RAL 7035

Connected load: 230 V / 0.85 kW

Dimensions HxWxD in mm: 1984 x 260 x 325

NOTE: Wall mounting imperative!

Not recommended for operation below an ambient temperature of 15°C.

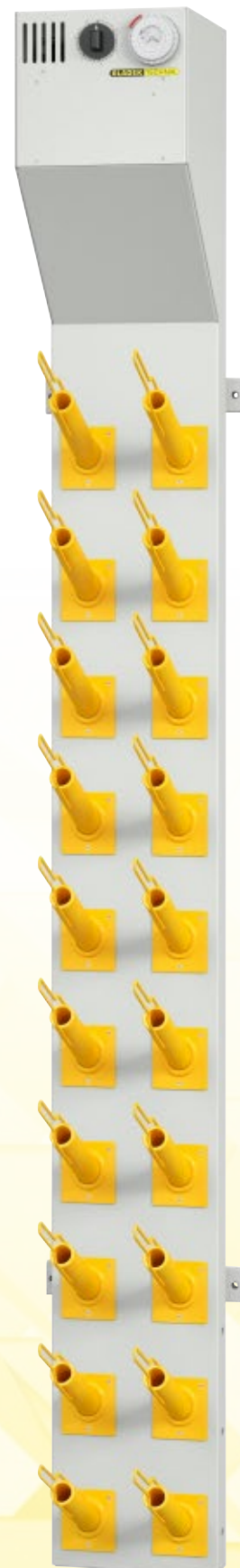

GT Glove 10 Power

Wall dryer



6 h timer

24 h programmable timer



GT For 4 Power wall dryer

2 internally ventilated shelf compartments for 2 helmets each

4 pairs of internally ventilated glove nozzles, 260 mm

4 pairs of internally ventilated shoe/boot nozzles, 320 mm, up to a shaft length of 360 mm

Ozone for germ and odour reduction

Circulating air fan, high-performance heating element

6 h timer and 24 h programmable timer

Connection cable 1800 mm including Schuko earthed plug

Wall dryer made of steel powder-coated in RAL 7035

Connected load: 230 V/ 1.9 kW

Dimensions HxWxD in mm: 1984 x 524 x 385

NOTE: Wall mounting imperative!

Not recommended for operation below an ambient temperature of 15°C.



GT For 4 Power

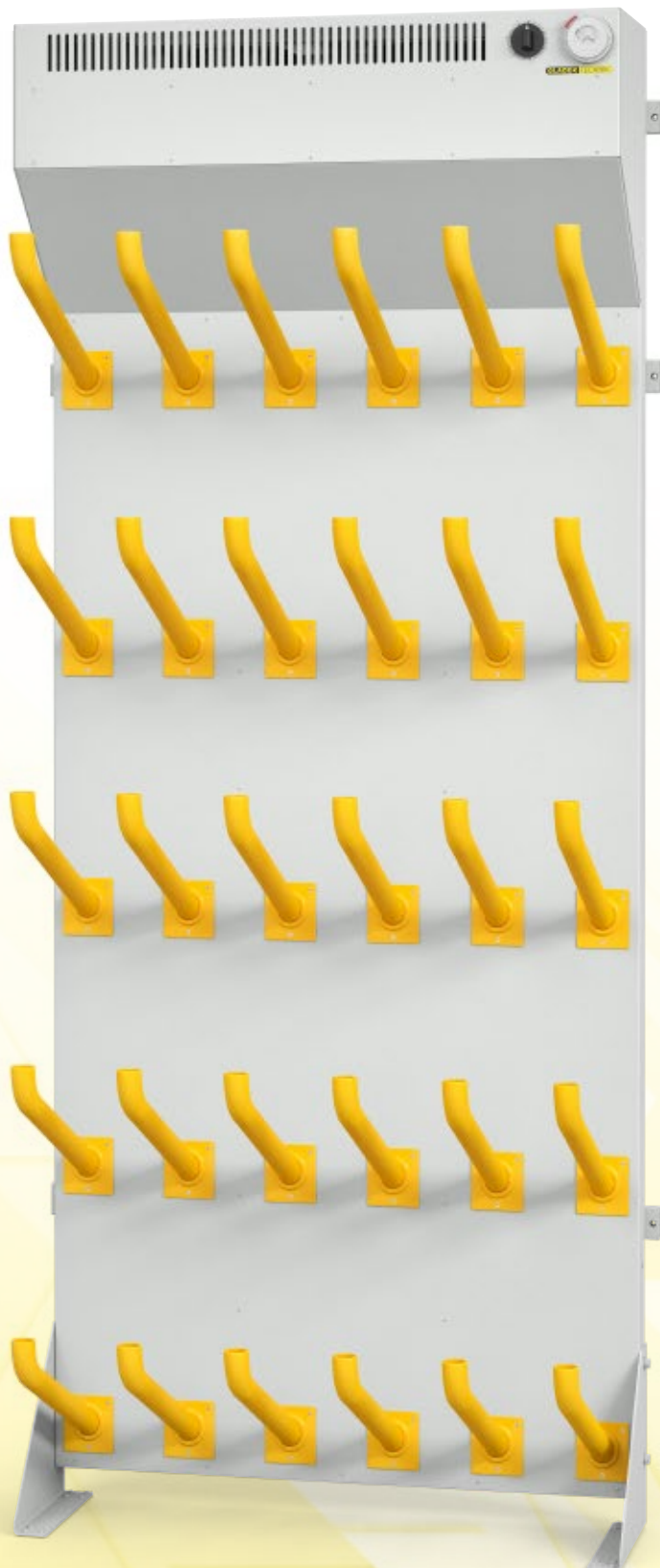

GT Boot 15 Power

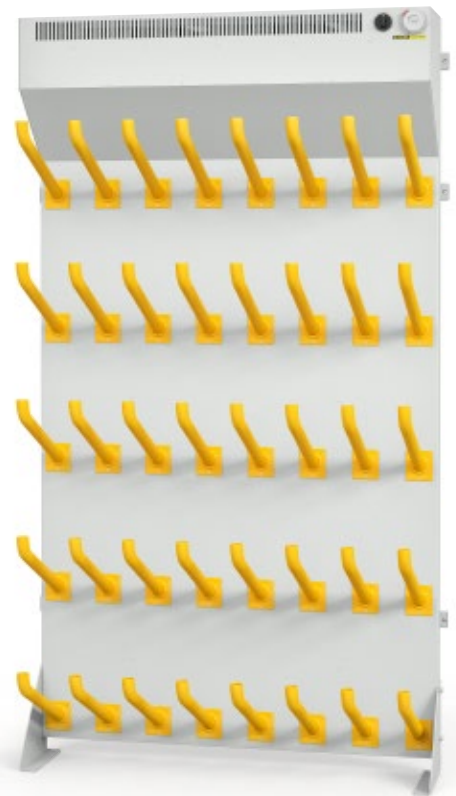

GT Boot 20 Power



GT Boot 15/20 Power wall dryer

15/20 pairs of internally ventilated shoe/boot nozzles, 320 mm, up to a shaft height of 360 mm

Ozone for germ and odour reduction

Circulating air fan, high-performance heating element

6 h t timer and 24 h programmable timer

Connection cable 1800 mm including Schuko earth-contacting plug

Wall dryer made of powder-coated steel, RAL 7035

Connected load: 230 V/ 1.9 kW

Dimensions HxWxD in mm: 2070 x 860/1148 x 385

NOTE: Wall mounting imperative! Not recommended for operation below an ambient temperature of 15°C.

Optional accessories (selection)



Internally ventilated glove nozzles from 260 mm-500 mm



Internally ventilated glove nozzles for greater spread



Internally ventilated shoe and boot nozzle from 260 mm-700 mm

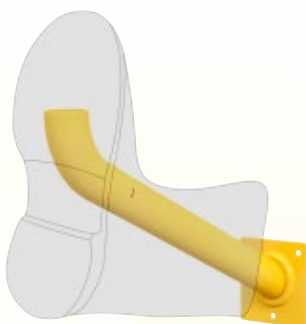

Internally ventilated mask nozzles



Internally ventilated helmet nozzle, open



Internally ventilated helmet nozzle, closed



Nozzle adapter plates, stainless steel, for greater flexibility

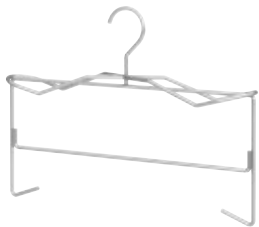

Clothes hanger specifically designed for jacket and trousers



Custom planning

Optimising every inch of space, we will plan the ideal locker or cabinet system for your changing rooms in close cooperation with you or your architect.

Locker or cabinet systems customised in size and outfit. We work on a solutions-focused basis.

On request, we can also give you servicing and maintenance contracts for all of our drying systems.

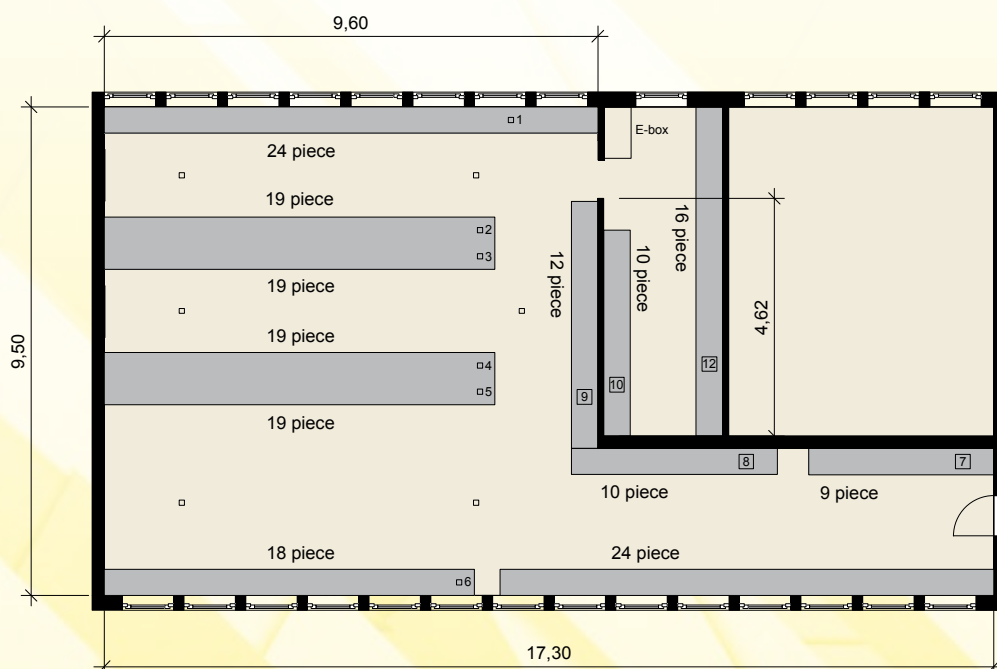



Environment

When it comes to storing and drying work clothing and equipment, **GLADEK TECHNIK** not only places its focus on guaranteeing hygiene and optimising use of space but also on making sure all resources are utilised as efficiently and sustainably as possible.

Particularly in relation to energy use, environmental protection and an awareness for sustainability.

GLADEK TECHNIK

Being a success begins with making the right decision.
At the right time. We look forward to talking to you.



 **swiss-engineering**

Retailer imprint

Gladek Technik Deutschland GmbH | In den Fichten 34 | D-32584 Löhne
Phone: +49 52 22 639 391 | www.locker-systems.com

Gladek Technik GmbH | Wylstrasse 7 | CH-6052 Hergiswil
Phone: +41 41 671 08 00 | www.gladek-technik.ch

Subject to technical modifications